

## GROUND LEVEL

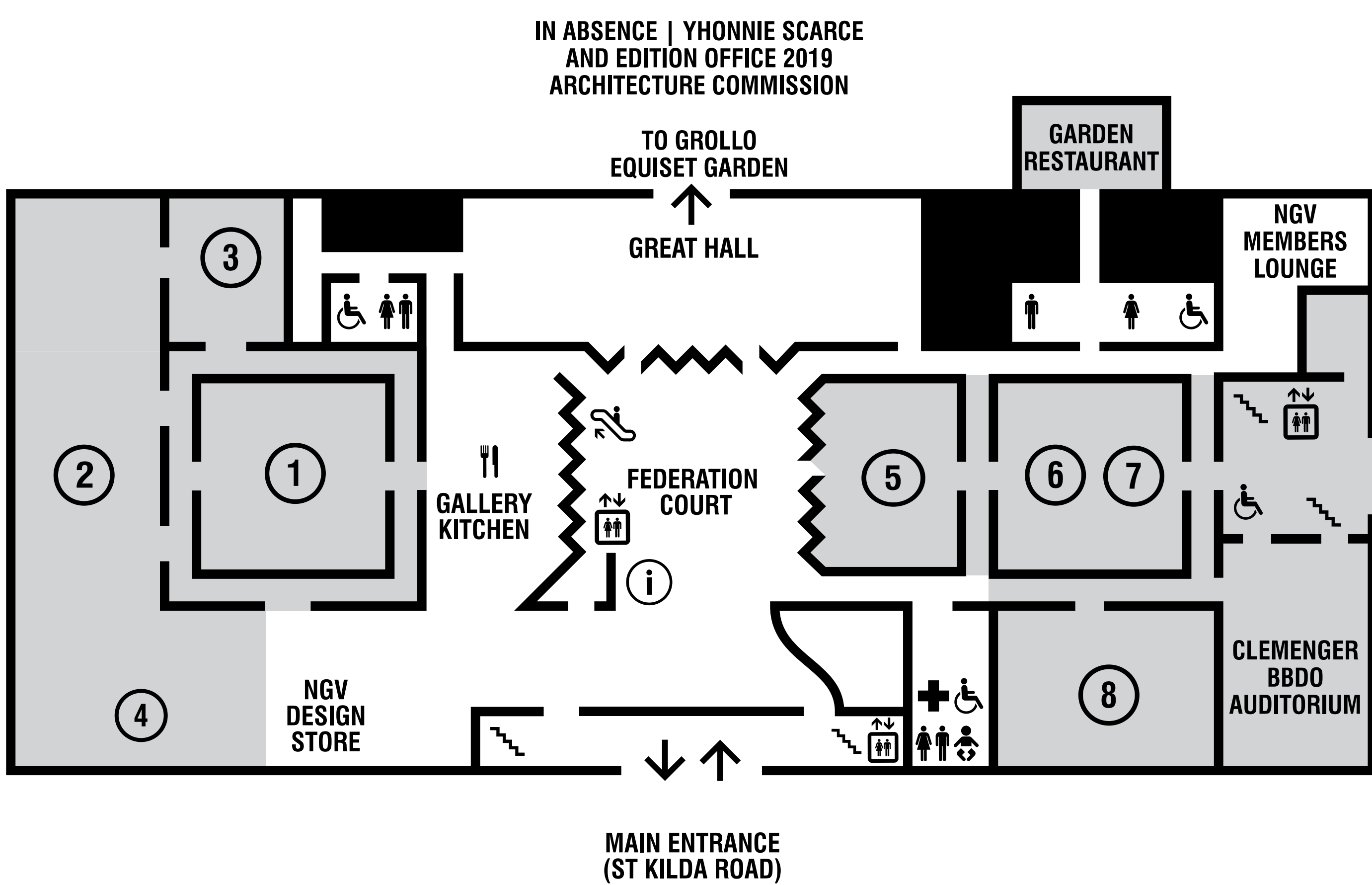

**1 – 8** Gallery in preparation

|                  |  |            |  |
|------------------|--|------------|--|
| Places to eat    |  | Escalators |  |
| Toilets          |  | Lift       |  |
| Information Desk |  | First Aid  |  |
| Baby Change      |  | Stairs     |  |

### STAY IN TOUCH

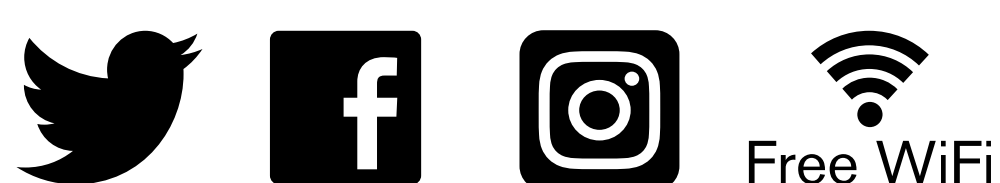

@NGVMelbourne #NGV

## LEVEL 1

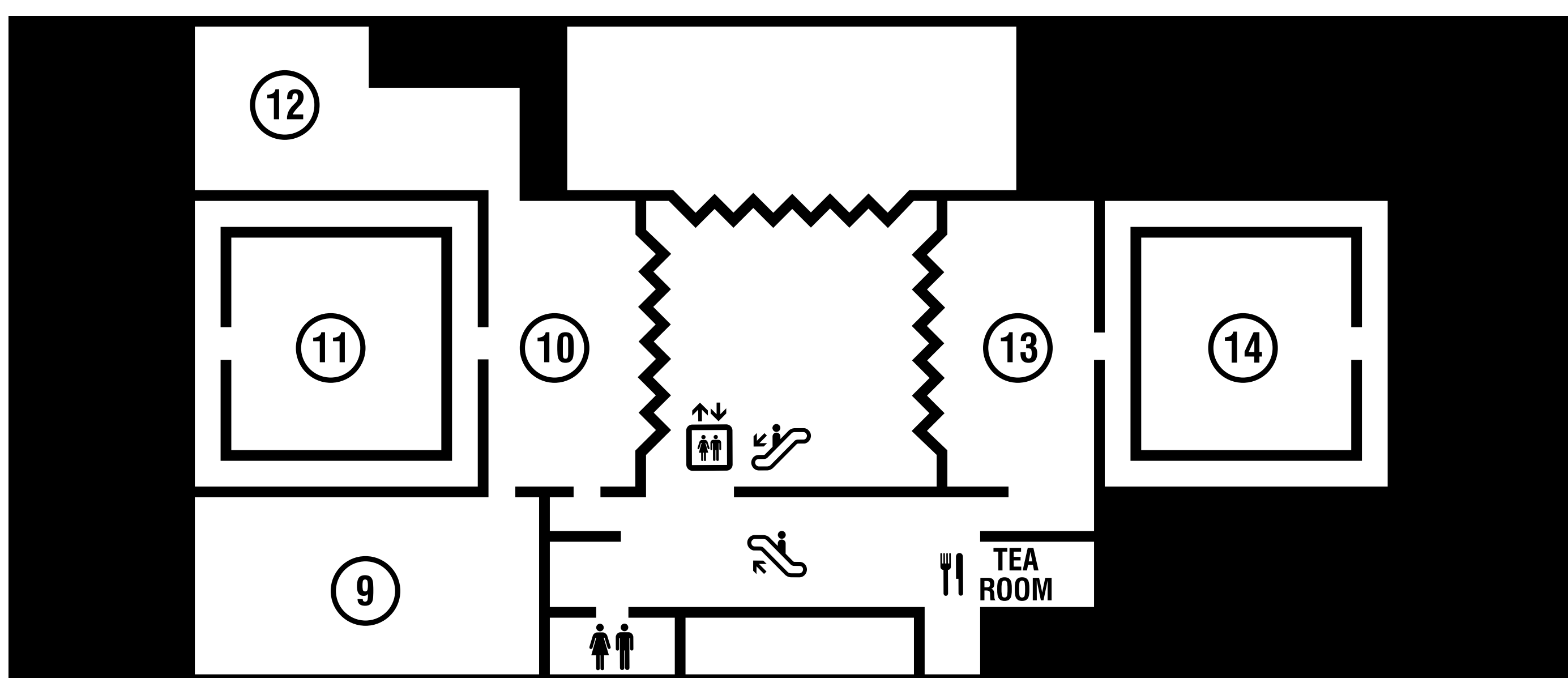

- 9 China
- 10 India, South & South-East Asia
- 12 Japanese Design: Neolithic to Now
- 13 Britain & Europe 13th–16th Century

## Mezzanine

- 11 Japanese Modernism, until 4 October 2020
- 14 Britain & Europe 15th–17th Century

Places to eat 

Toilets  

Escalators 

Lift 

---

STAY IN TOUCH

---

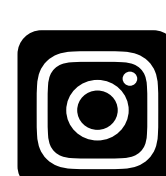

Free WiFi

@NGVMelbourne #NGV

## LEVEL 2

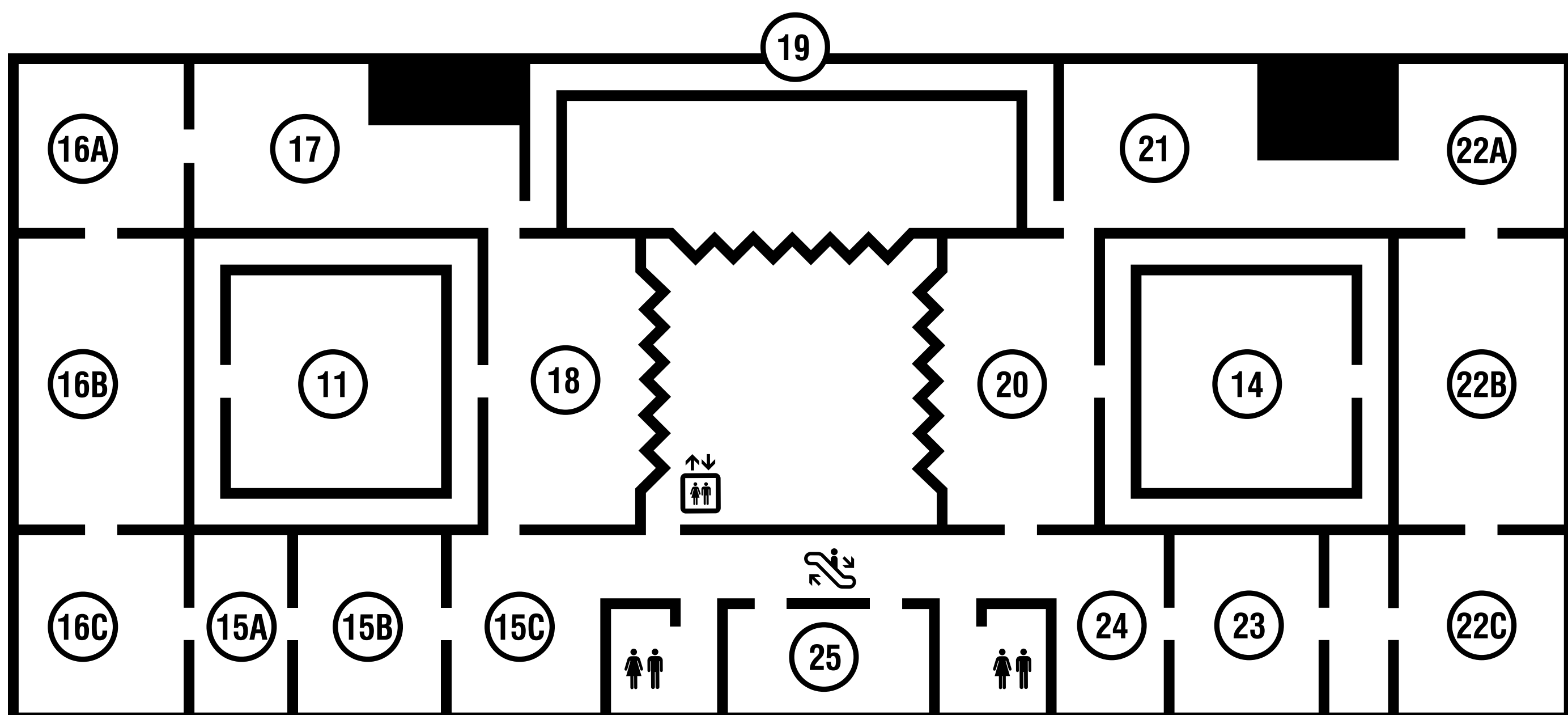

- 15 16 17** International Collection 19th–20th Century
- 18** International Collection 19th–20th Century;  
Krystyna Campbell-Pretty AM and Family  
Suffrage Research Collection
- 19** Liquid Light: 500 Years of Venetian Glass, until 23 August 2020
- 20 21 22 23 24** Britain & Europe 16th–18th Century
- 25** Mesoamerica, Greece, Italy, Egypt, Cyprus & the Near East  
3500 BCE – 16th Century

### Mezzanine

- 11** Japanese Modernism, until 4 October 2020
- 14** Britain & Europe 15th–17th Century

- Toilets  
- Escalators 
- Lift 

### STAY IN TOUCH

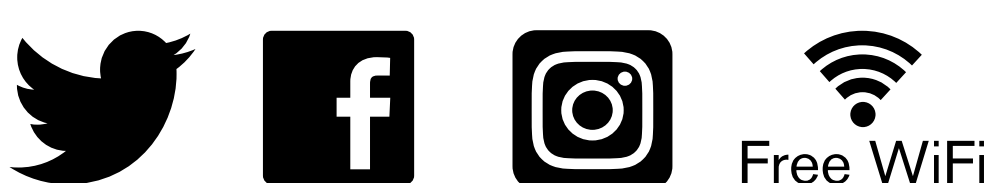

@NGVMelbourne #NGV

## LEVEL 3

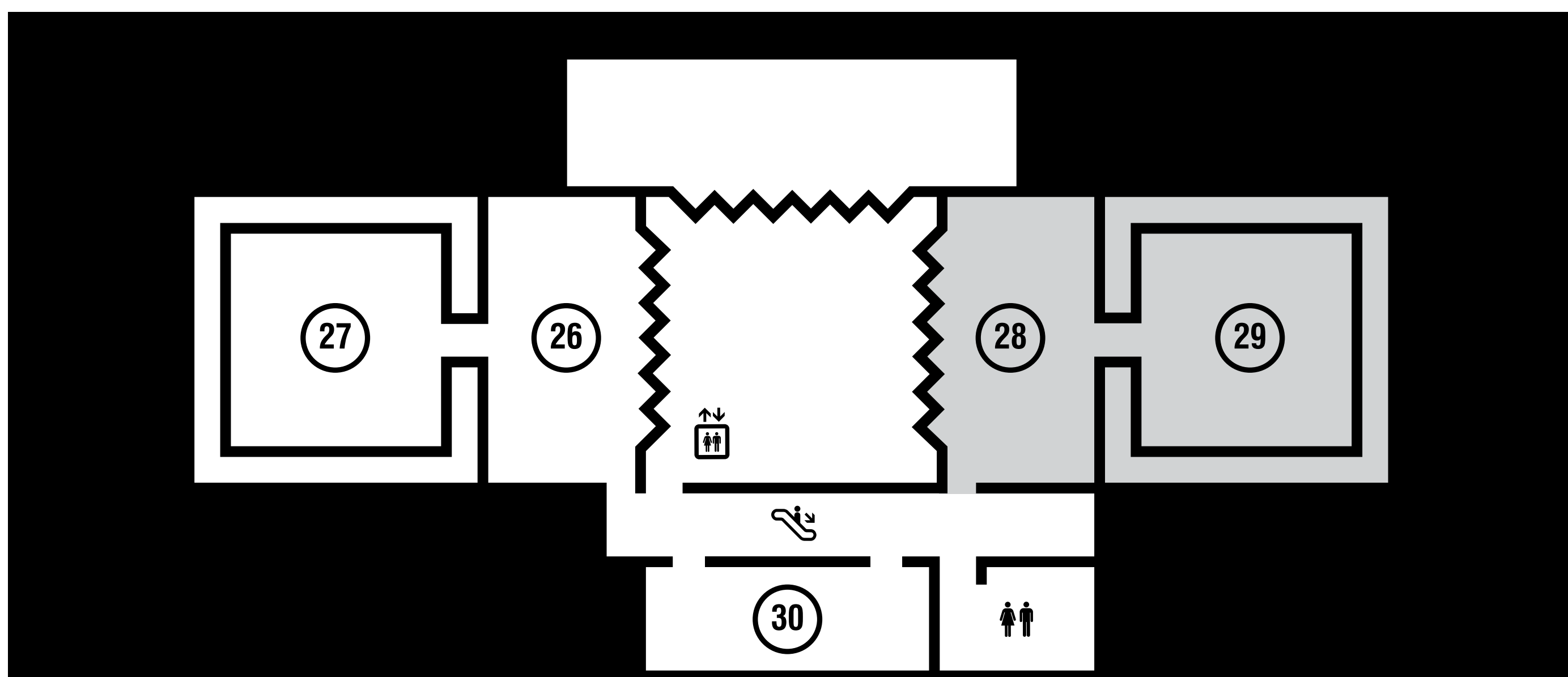

**26** **27** Collecting Comme, until 30 August 2020

**28** **29** Gallery in preparation

**30** Colin McCahon: Letters and Numbers, until 30 August 2020

Toilets  

Escalators 

Lift 

---

STAY IN TOUCH

---

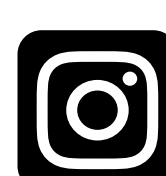

Free WiFi

@NGVMelbourne #NGV